



**PETONEER**

[www.petonner.com](http://www.petonner.com)

## Smart Odor Eliminator User Manual

**Model: AOE010**

Please read this manual carefully before using.  
Keep the manual in a safe place for future reference.

## Inside the box

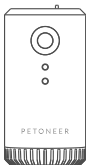

Smart Odor  
Eliminator



Foam Sticker



Metal Plate  
Sticker

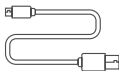

Micro USB Cable

## Meet your odor eliminator

Infrared Sensor

Status LED

Solid Blue: Working

Slow Blinking Blue:

Triggered by timer(Mode II)

Off: Standby

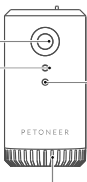

Battery

Status LED

Solid Red: Battery

charging process

Solid Green: Battery  
is fully charged)

Ozone Emitting Holes

**How it works:** The Built-in ozone generator converts  $O_2$  in the air to  $O_3$ .  $O_3$  which has active oxidizing properties, which can, at the source in the cat toilet, decompose the odor molecules and re-convert it into harmless. It can also destroy the cell membrane structure of bacteria and has a certain sterilization effect.

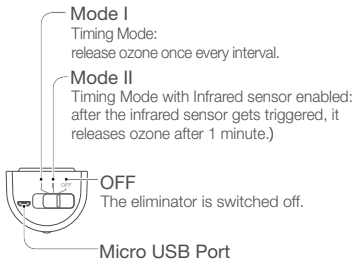

## Operations:

1. Paste the metal plate onto the foam sticker and attach the sticker to the position you expect.



2. For closed cat toilet: Stick the foam sticker onto the cat toilet hood;  
For open cat toilet: Stick the foam sticker onto the wall near the cat toilet (about 5cm above the cat toilet);  
For other scenarios, place the device closer to the odor source.

3. Press firmly onto the metal plate to secure it.

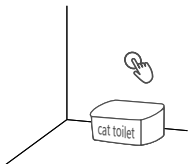

4. The eliminator can be mounted onto the metal plate.



5. Select the working mode:  
Switch from OFF to your desired mode.



## 6. Charging

Remove the eliminator and connect the power supply for charging which takes about 3 hours.

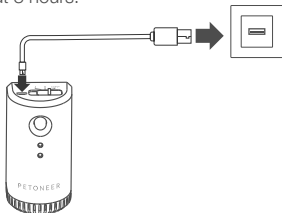

## Specification

**Model:** AOE010

**Size:** 3.92x2.04x1.63 inches  
(99.6x51.7x41.5mm)

**Weight:** 5.4 oz (153 g)

**Battery:** Lithium 2200 mAh

**Working modes:**

Triggered by timing or Infrared

**Infrared Detection Range:** about 1 m or 3.3 ft

\*All Pictures shown in the manual are for illustration purpose only. Actual product may vary due to product enhancement.

## Precautions

1. This product is not waterproof, NEVER wash directly into the water;
2. DO NOT replace the battery or disassemble it yourself;
3. DO NOT block the air outlet and keep proper ventilation;
4. If kids are using the product, be sure the guidance of an adult is present;
5. Mode I is recommended to use ONLY in the environment where no human or pet is present.

## Warranty Terms

Within the period of warranty, if the product fails with no fault of user operations, it will be repaired at Petoneer's expense. Product failure in examples below will not be covered by the warranty:

- 1). Intentional damage to product by user or third party.
- 2). Failure to operate or maintain the product in accordance with the Quick Installation Guide (QIG) instructions.
- 3). Failure by natural wear and tear including but not limited to scratching, corrosion, oxidation and rusting.
- 4). Failure by non-authorized repair of the product including but not limited to user's own or third-party repairing attempts or modifications.